

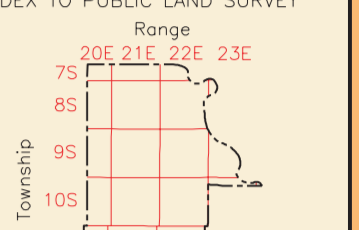

GEOLOGIC MAP OF LEAVENWORTH COUNTY, KANSAS 1998

Geology mapped by
James R. McCauley

Computer compilation
and cartography by
Jorgina A. Ross
Bryce Kohl
Sunyup Park
Kim S. Yap

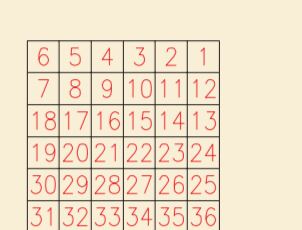
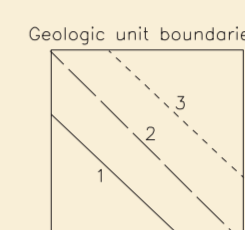
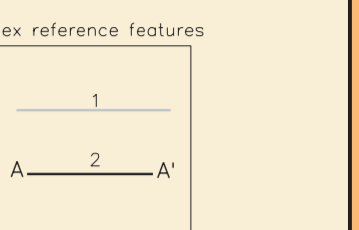
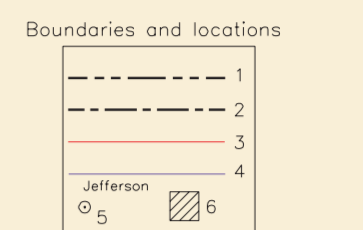
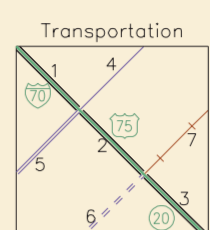
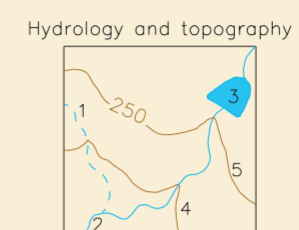

INDEX TO 1:24,000-SCALE MAPS

- | | |
|------------------------------|----------------------------------|
| 1 Potter - 1960 (79 PG) | 10 Bowler - 1949 (79 PG) |
| 2 Oak Mills - 1961 (79 PG) | 11 Watson - 1948 (79 PG) |
| 3 Weston - 1968 (79 PG) | 12 Kober - 1950 (79 PG) |
| 4 Easton SW - 1961 (79 PG) | 13 Tonganoxie - 1950 (79 PG) |
| 5 Easton NE - 1961 (79 PG) | 14 Bowler Springs - 1950 (79 PG) |
| 6 Leavenworth - 1961 (79 PG) | 15 Lawrence East - 1950 (79 PG) |
| 7 Potter City - 1961 (79 PG) | 16 Eaton - 1951 (79 PG) |
| 8 McCauley - 1950 (79 PG) | 17 De Soto - 1951 (79 PG) |
| 9 Juntura - 1948 (79 PG) | 18 Photorevised |

| Composite Stratigraphic Section | Member | Formation | Group | Series | System |
|---------------------------------|--|-------------------------|-------------|--------|---------------|
| Qal | | Alluvium | | | QUATERNARY |
| Ql | | Loess | | | QUATERNARY |
| Ogd | | Glacial Drift | | | QUATERNARY |
| Pqd | Ervine Creek Ls Lawn Springs Sh Rock Shuff Ls Ogden Sh Zwickel Ls | Deer Creek Ls | | | QUATERNARY |
| Pst | | Tacumseh Sh | | | SHOSHONE |
| Pal | Alton Ls Kang Hill Sh Garden Hill Sh Dunlap Sh Spring Branch Ls | Lecompton Ls | | | SHOSHONE |
| Psk | Stall Sh Clay Creek Ls Jackson Park Sh Kerford Ls Humboldt Ls Plattsmouth Ls Leavenworth Ls Snyder Ls Lorenzo Ls | Kanwaka Sh | | | SHOSHONE |
| Pso | | Dread Ls | | | SHOSHONE |
| Pdl | Unmetamorphosed shale Amazonia Ls | Lawrence | | | PENNSYLVANIAN |
| Pds | Robbins Sh Haskell Ls Vilard Sh Westphalia Ls Tonganoxie Sh Iatan Ls | Stranger | Douglas | | PENNSYLVANIAN |
| Pis | South Bend Ls Rock Hill Ls Stanton Ls Lillian Ls Lillian Creek Ls | Stanton Ls | Lansing | | PENNSYLVANIAN |
| Piv | Spring Hill Ls Hickory Creek Sh Merrimack Sh Bonner Spgt. Sh | Viles Sh | | | MISSOURIAN |
| Pip | | Plattsburg Ls | | | MISSOURIAN |
| Pkw | Farley Ls Island Creek Sh Argentine Ls Quincy Sh Frisbe Ls | Lane Sh Wyandotte Ls | Kansas City | | MISSOURIAN |

EXPLANATION

| | | |
|--|--|--|
| | | |
| | | |
| | | |
| | | |



Convergence (GN) and 1981 magnetic declination (MN) at center of map. Diagram is approximate.

Lambert Conformal Conic Projection with standard parallels at 33° and 45°

SCALE 1:50,000

0 1 2 3 Miles
0 1 2 3 Kilometers

Deviation contours are presented for general reference. They are taken from USGS Digital Line Graph (DLG) files compiled from base maps of a scale of 1:100,000. In some places the contours from the DLG may be more generalized than the base maps used for compilation of geologic outcrop patterns. Outcrop patterns on the map will typically reflect topographic variation more accurately than the associated contour lines. Repeated fluctuation of an outcrop line across a contour line should be interpreted as an indication that the mapped rock unit is maintaining a relatively constant elevation along a generalized contour.

This map was produced by computer-aided cartography using the GIMMS (Geographic Information Management System Analysis and Production) system developed at the Kansas Geological Survey. The Kansas Geological Survey does not guarantee this map to be free from errors or inaccuracies and disclaims any responsibility or liability for interpretations made from the map or decisions based thereon.

Suggested reference to this map:
McCauley, J., 1998. Geologic Map of Leavenworth County, Kansas. Kansas Geological Survey, Map M-53, scale 1:50,000.

CONVERSION TABLE

| | | | |
|------------|-------------|-------------|-------------|
| feet | 0.3048 | 0.0003048 | 0.000003048 |
| meters | 1 | 0.001 | 0.000001 |
| kilometers | 0.0010936 | 0.0010936 | 0.0010936 |
| miles | 0.000621371 | 0.000621371 | 0.000621371 |

To convert feet to meters multiply by 0.3048
To convert meters to feet multiply by 3.2808
To convert kilometers to miles multiply by 0.6214
To convert miles to kilometers multiply by 1.6094